

DRI-DESIGN[®] METAL WALL PANELS

Technical Data

Aluminum



Aluminum, dry joint, rainscreen, pressure equalized wall panel systems that are truly dry joint... without sealants or gaskets.

SWIRNOW
ARCHITECTURAL
WALL SYSTEMS LLC

Panel Depth:	1 ¼"
Panel Joints:	½" nominal
Material Thickness:	.062 for panels 36" or smaller; .080 available for any size
Panel Corners:	Welded
Weight:	.062 panels weigh about 1 pound per square foot .080 panels weigh about 1½ pounds per square foot
Finishes:	Kynar, 50% and 70% Resins Metallic Anodized Spatter Coatings
Colors:	Any color, no standards
Best Size:	For lowest cost *.062 - 36" x 36" *.080 - 40" x 40"
Packaging:	Polymask on all panels Boxes and/or crates
Details:	Extrusions (refer to product details) Formed Flashing
Corners:	Custom soldered Formed flashings
Substrate Requirements:	A substrate is required A weather barrier is required Subgirts are required
Testing:	ASTM E 283 for Air - passed ASTM E 331 for Water - passed ASTM E 330 for Structural - 65 psf



Size Limitations:

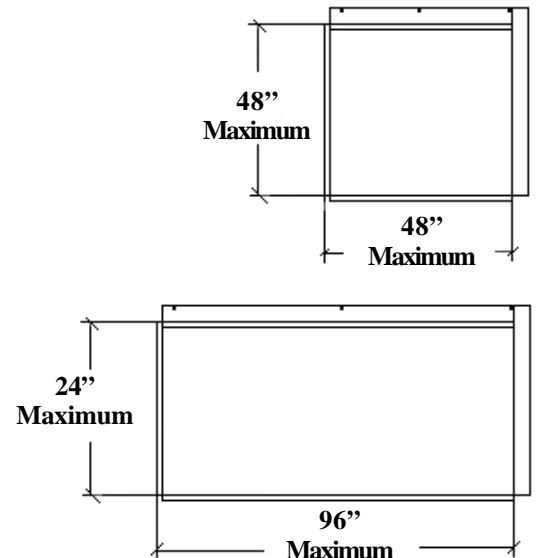

Main Office
2801 Sisson Street
Baltimore, Maryland
21211-2902
Fax: 410.338.1124
800.338.8833
410.338.1122
www.swirnow.com

This information is subject to change without notice.

Swirnow Building SystemsSM is a registered service mark of Swirnow Building Systems Management LLC used under license